

KINGSTON

KITCHEN & BATH

INSTALLATION INSTRUCTIONS Touch-Toe Tub Drain Replacement Kit

Tools and supplies needed for installation:

• Phillips head screwdriver • Spatula • Rags • Silicon based caulking • 4 Way drain wrench or Dumbbell drain wrench • Crescent wrench • Pipe thread sealant or Teflon tape.

Installation:

1. Remove cover plate screws.
2. Carefully remove overflow plate with lever and entire linkage assembly.
3. Install the overflow adapter plate using two screws (included)
4. Thread overflow cap into the center hole of the adapter plate, hand tighten only.
5. Remove bath drain using a 4 way wrench or a dumbbell wrench.
6. Remove debris from inside threads and around the drain flange.
7. Apply a small bead of silicone based caulking around the perimeter of the drain hole.
8. Your kit is equipped with a coarse thread adapter, if you do need to use it, apply Teflon tape or pipe thread sealant to the drain and thread adapter onto the drain.
9. Apply Teflon tape or thread pipe sealant to the outside threads of the drain and thread onto the drain shoe using a 4 way wrench or a dumbbell wrench.
10. With the stopper in the open position, thread into drain.

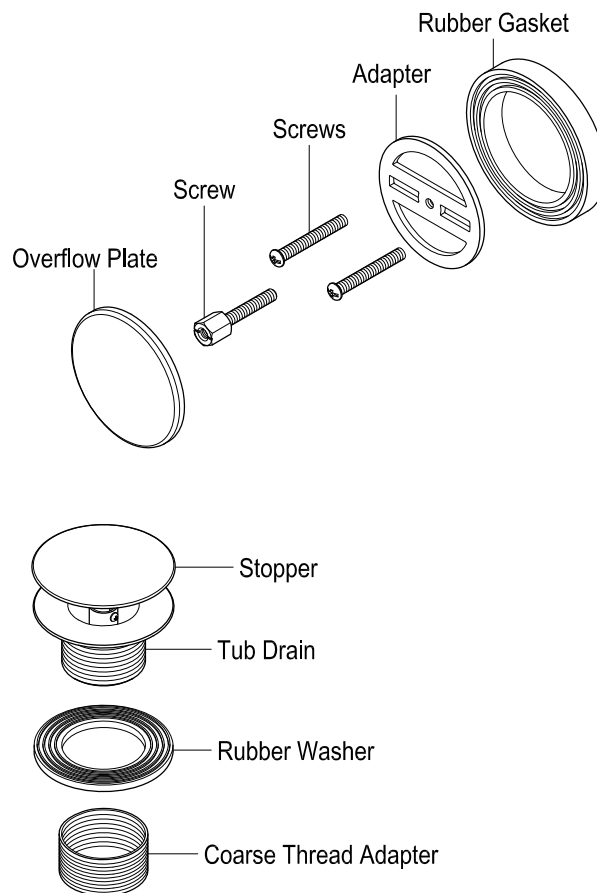

www.kingstonbrass.com

TOLL-FREE CUSTOMER SERVICE: 1-877-2-KBRASS

TECHNICAL SUPPORT E-mail: service@kingstonbrass.com

12775 Reservoir Street, Chino, CA 91710

© 2021-08-T Kingston Brass